

## Fitness Board®

Fitness Board® is a sports floor manufactured from natural wood intended for interiors used for a wide range of fitness activities, including aerobics and yoga studios, dance and choreography halls, as well as indoor courts used for hosting dance competitions, shows, presentations and other public events.

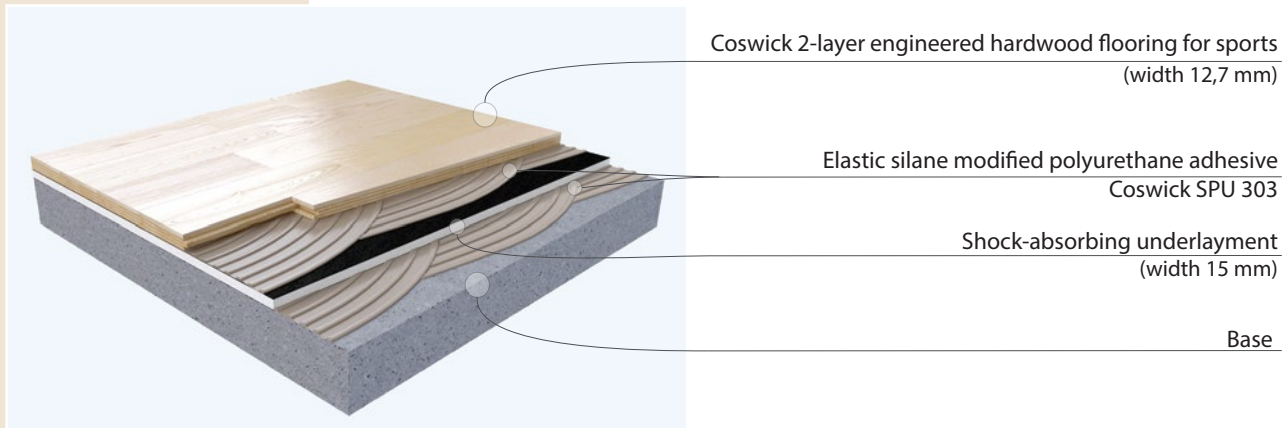

Intended Use	Intended for use in most types of fitness centres, choreography studios, as well as interiors used for holding sports-dance competitions and other public events.
Technology	Floor covering manufactured from natural hardwood; two-layer engineered flooring boards installed over shock-absorbing underlayment. Product has "deck" - style surface pattern.
Compliance with	
Shock absorption, %	59   EN 14808 (A4 ≥55%<75%)
Vertical deformation, mm	3,8   EN 14809 EN 14809 (A4 ≥2,3<5)
Friction, nominal unit	93   EN 13036-4 (80-110)
Ball bounce, %	99   EN 12235 (≥90%)
Rolling load, mm	0,28   EN 1569 (≤0,5 mm, min 1500 H)
Top Layer	
Species	Oak, ash
Construction	2-layer engineered hardwood floor board
Dimensions	12,7x107,95x300...1850 mm
Subfloor	Shock-absorbing underlayment, installed over elastic glue
System Type	Permanent stationary system, fixed to base using glue-down method.
Installation	Glue-down installation (Silane based adhesive Coswick SPU 303)
Warranties	Lifetime structural integrity warranty

### Baseboard and Reducer

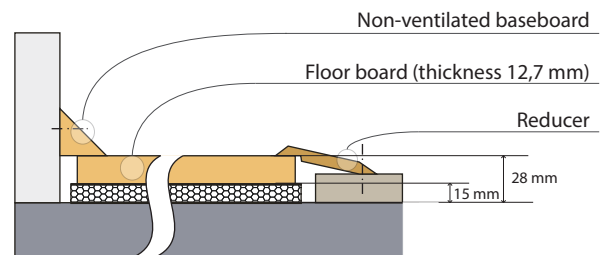

### Serviceable Cable Channel

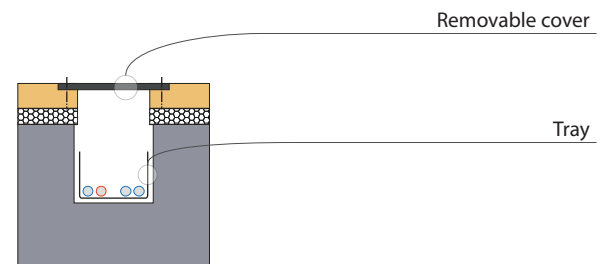

### Breakout Box

